

2000nm 3-port Optical Circulator for Pulse Power

FEATURES

- ▣ High Isolation
- ▣ Low Insertion Loss
- ▣ Epoxy-Free Optical Path
- ▣ High Reliability and Stability
- ▣ Low Profile Packaging

APPLICATIONS

- ▣ Fiber Optic Amplifiers
- ▣ Fiber Optic Instruments
- ▣ WDM Systems
- ▣ Dispersion Compensation
- ▣ Light Routing

SPECIFICATIONS

Parameter	Unit	Value	
Center Wavelength (λ_c)	nm	2000	
Bandwidth	nm	+/-30	
Insertion Loss@23°C	(Typ.)	dB	1.3
	(Max.)	dB	1.8
Isolation@23°C	(Typ.)	dB	20
	(Min.)	dB	16
PDL	dB	≤ 0.2	
Optical Return Loss	dB	≥ 45	
Cross Talk	dB	≥ 40	
Fiber Type	-	SMF-28 Fiber or SM1950 Fiber (V) 10/130um DC Fiber (O) or 25/250um DC Fiber (R)	
Fiber Tensile Load	N	5	
Max. Average Optical Power	W	0.3, 0.5, 1, 2, 3, 5, 10, 15, 20	
Max. Peak Power for Pulse	kW	0.1, 1, 2, 3, 5, 10, 15, 20	
Operating Temperature	°C	0~50	
Storage Temperature	°C	-40~85	

- Note:**
1. Specifications are for device without connectors; Specifications may change without notice.
 2. To add connectors, IL is 0.3dB higher, RL is 5dB lower.
 3. Only guarantee 1W continuous wave (CW) power thru testing for connectors added.
 4. Devices for higher optical power or with other type fiber or consigned fiber are also available; Devices can only work in the core of Double Cladding (DC) Fiber, Cladding Power must be stripped before connecting the device.
 - 5 Package size may be different for different optical power and fiber types.

PACKAGE DIMENSION

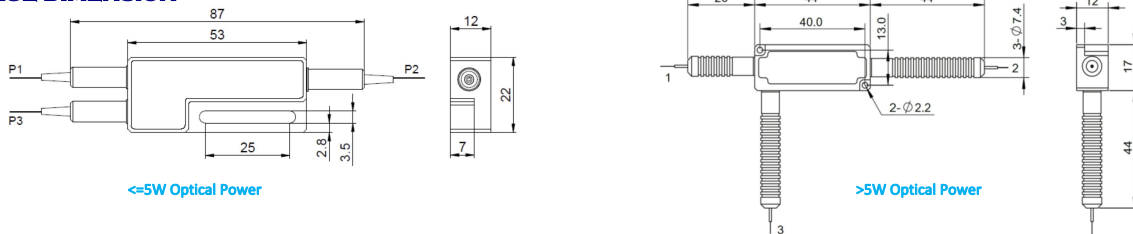

ORDERING INFORMATION (PN)

FCIR-	N N N N	-3H NN	P NN	- (NN)	- (C)	C	NN	-	CC/CCC
Center Wavelength	Average Power	Peak Power	Average Power P2	Fiber Type	Fiber Sleeve	Fiber Length	Connector Type		
2000-2000nm	03-300mW	01-100W	1- 1W	V-SM1950 Fiber	B= Bare fiber	05-0.5m	N=Without Connector		
	1- 1W	1- 1kW	2- 2W	O=10/130 DC Fiber	L= Loose Tube	10=1.0m	FC/APC=FC/APC Connector		
	5- 5W	5- 5kW	5-5W	R=25/250 DC Fiber	2= 2mm Cable	15=1.5m	LC/PC=LC/PC Connector		
	10-10W	10-10kW	Blank for P2=P1	Blank for SMF-28 Fiber	3= 3mm Cable	20=2.0m	SC/UPC=SC/UPC Connector		