

910~960nm High Power Faraday Mirror

FEATURES

- High Isolation
- Low Insertion Loss
- Epoxy-Free Optical Path
- Low Polarization Sensitivity
- Low Profile Packaging

APPLICATIONS

- Fiber Optic Amplifiers
- Sensing Systems
- Telecommunication Networks
- CATV Networks
- LAN Systems

SPECIFICATIONS

| Parameter | Unit | Value | |
|--------------------------------------|---------------|--|--|
| Center Wavelength (CW) | nm | 915, 930, 940, 950 | |
| Bandwidth | nm | +/-10 | |
| Insertion Loss | Typ. | dB | 0.9 |
| | Max. | dB | 1.8 |
| Faraday Rotation Angle (Single Pass) | Deg | 22.5, 45, 90 | |
| Rotation Angle Tolerance (CW, 23°C) | Deg | +/-5 | |
| PDL (for SM Fiber Type) | dB | ≤0.20 | |
| Extinction Ratio (for PM Fiber Type) | dB | ≥18 | |
| Fiber Type | SM Fiber Type | - | HI780 Fiber, HI1060 Fiber or 10/125um SC Fiber (E) |
| | | - | 10/125um DC Fiber (O), 15/130um DC Fiber (W) |
| | | - | 20/130um DC Fiber (Q) or 25/250um DC Fiber (R) |
| | PM Fiber Type | - | PM850 Fiber, PM980 Fiber or PM1060L Fiber (E) |
| | | - | 10/125um PMDC Fiber (O) or 15/130um PMDC Fiber (W) |
| | | - | 20/130um PMDC Fiber (Q) or 25/250um PMDC Fiber (R) |
| Fiber Tensile Load | N | 5 | |
| Maximum Optical Power (CW) | W | 0.3, 0.5, 1, 2, 3, 5, 10, 15, 20, 30, 40, 50 | |
| Operating Temperature | °C | 0~50 | |
| Storage Temperature | °C | -20~75 | |

- Note:**
1. Specifications are for device without connectors; Specifications may change without notice.
 2. To add connectors, IL is 0.7dB higher, RL is 5dB lower, ER is 2dB Lower, Connector key is aligned to slow axis.
 3. Only guarantee 1W continuous wave (CW) power thru testing for connectors added.
 4. Devices for higher optical power or with other type fiber or consigned fiber are also available; Devices can only work in the core of Double Cladding (DC) Fiber, Cladding Power must be stripped before connecting the device.

DIMENSION DRAWING

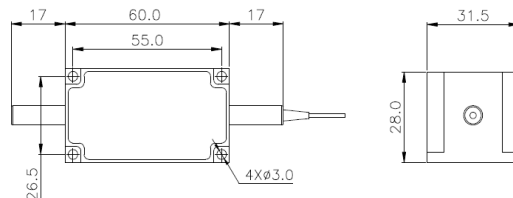

ORDERING INFORMATION (PN)

| FFDM- NNN | - (NN) | -HP NN | - C | (C) | C | NN | - CC/CCC |
|-------------------|--------------------|---------------|-------------|--------------------------------|---------------|--------------|-------------------------|
| Center Wavelength | Rotation Angle | Optical Power | Fiber Type | Fiber Type | Fiber Sleeve | Fiber Length | Connector Type |
| 915-915nm | 90= 90degree | 03=300mW | P= PM Fiber | H=HI1060 or PM980 Fiber | B= Bare Fiber | 05=0.5m | N=Without Connector |
| 930-930nm | 225=22.5degree | 1= 1W | S=SM Fiber | E=10/125 SC or PM1060L Fiber | L= Loose Tube | 10=1.0m | FC/APC=FC/APC Connector |
| 940-940nm | Blank for 45degree | 5=5W | | R=25/250 DC or PMDC Fiber | 2= 2mm Cable | 15=1.5m | LC/PC=LC/PC Connector |
| 950-950nm | | 10=10W | | Blank for HI780 or PM850 Fiber | 3= 3mm Cable | 20=2.0m | SC/UPC=SC/UPC Connector |