

## 2000nm High Power PBC(PBS)/Isolator Hybrid

### FEATURES

- High Isolation
- Low Insertion Loss
- Epoxy-Free Optical Path
- High Reliability and Stability
- Low Profile Packaging

### APPLICATIONS

- Fiber Optic Amplifiers
- Fiber Optic Instruments
- WDM Systems
- Transmitters and Fiber Lasers
- CATV Networks



### SPECIFICATIONS

Parameter	Unit	Single Stage	Dual Stage	H Stage
Center Wavelength ( $\lambda_c$ )	nm	2000		
Isolation ( $\lambda_c \pm 20\text{nm}$ , 23°C)	dB	$\geq 20$	$\geq 35$	$\geq 25$
Insertion Loss ( $\lambda_c \pm 20\text{nm}$ , 23°C)	dB	$\leq 1.6$	$\leq 1.9$	$\leq 1.9$
Optical Return Loss (Input/Output)	dB	50/45	50/45	50/45
Extinction Ratio	dB	$\geq 18$		
Fiber Type of Port 3	S Type	-	Corresponding SM Fiber	
	P Type	-	Same Fiber to Port1&2, Slow axis align to Port 1	
	Q Type	-	Same Fiber to Port1&2, Slow axis is 45° to Port 1	
Fiber Type of Port1 & Port2	-	PM1550 Panda Fiber or PM1950 Fiber (V) 10/130um PMDC Fiber (O) or 25/250um PMDC Fiber (R)		
Fiber Tensile Load	N	5		
Maximum Optical Power (CW)	W	1, 2		3, 5, 10, 15, 20
Operating Temperature	°C	0~50		
Storage Temperature	°C	-20~75		
Package	Stainless Steel Tube (SST)	mm	$(\Phi)5.5 \times 35$	
Dimension	Metal Box-M	mm	$(L)120 \times (W)12 \times (H)10$	

- Note:**
1. Specifications are for device without connectors; Specifications may change without notice.
  2. To add connectors, IL is 0.3dB higher, RL is 5dB lower, ER is 2dB Lower, Connector key is aligned to slow axis.
  3. Only guarantee 1W continuous wave (CW) power thru testing for connectors added.
  4. Devices for higher optical power or with other type fiber or consigned fiber are also available; Devices can only work in the core of Double Cladding (DC) Fiber, Cladding Power must be stripped before connecting the device.

### PACKAGE DIMENSION (H STAGE)

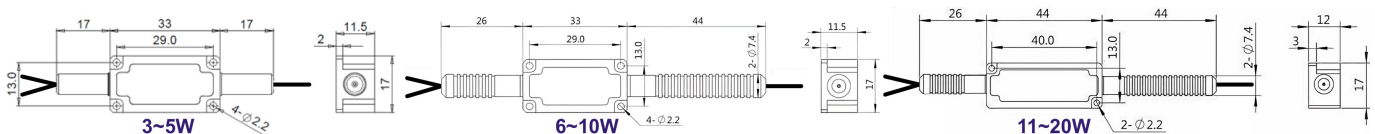

### ORDERING INFORMATION (PN) FHIC=PBC/Isolator Hybrid; FHIS=PBS/Isolator Hybrid.

FHIC FHIS	-NNNN	- C	C	-HP NN	-(C)	C	C	NN	-CC/CCC
	Center Wavelength	Stage	3rd Port Fiber	Optical Power	Package	Fiber Type	Fiber Sleeve	Fiber Length	Connector Type
	2000-2000nm	S= Single Stage	S=S Type	1-1W	M= Metal Box	2=PM1550Fiber	B= Bare fiber	05=0.5m	N=Without Connector
		D= Dual Stage	P=P Type	5=5W	Blank for SST	V=PM1950 Fiber	L= Loose Tube	10=1.0m	FC/APC=FC/APC Connector
		H= H Stage	Q=Q Type	10=10W	or >2W Power	O=10/130 PMDC Fiber	2= 2mm Cable	15=1.5m	LC/PC=LC/PC Connector
				20=20W		R=25/250 PMDC Fiber	3= 3mm Cable	20=2.0m	SC/UPC=SC/UPC Connector