

## 460~690nm 3-port Optical Circulator

### FEATURES

- High Isolation
- Low Insertion Loss
- Epoxy-Free Optical Path
- High Reliability and Stability
- Low Profile Packaging

### APPLICATIONS

- Fiber Optic Amplifiers
- Fiber Optic Instruments
- WDM Systems
- Dispersion Compensation
- Light Routing

### SPECIFICATIONS

Parameter	Unit	Value	
Center Wavelength	nm	460, 488, 520, 532, 635, 650, 600, 690	
Bandwidth	nm	+/-5	
Insertion Loss@23°C	(Typ.)	dB	1.3
	(Max.)	dB	2.5
Isolation@23°C	(Typ.)	dB	19
	(Min.)	dB	16
Optical Return Loss	dB	≥25	
Cross Talk	dB	≥25	
Fiber Type	-	50/125um MM Fiber, 62.5/125um MM Fiber OM3 MM Fiber	
Fiber Tensile Load	N	5	
Maximum Optical Power (CW)	mW	30	
Operating Temperature	°C	10~50	
Storage Temperature	°C	-10~65	

- Note:**
1. Specifications are for device without connectors; Specifications may change without notice.
  2. To add connectors, IL is 0.3dB higher, RL is 10dB lower.
  3. Specifications are tested at low order modes.
  4. Devices for higher optical power or with other type fiber or consigned fiber are also available.

### PACKAGE DIMENSION

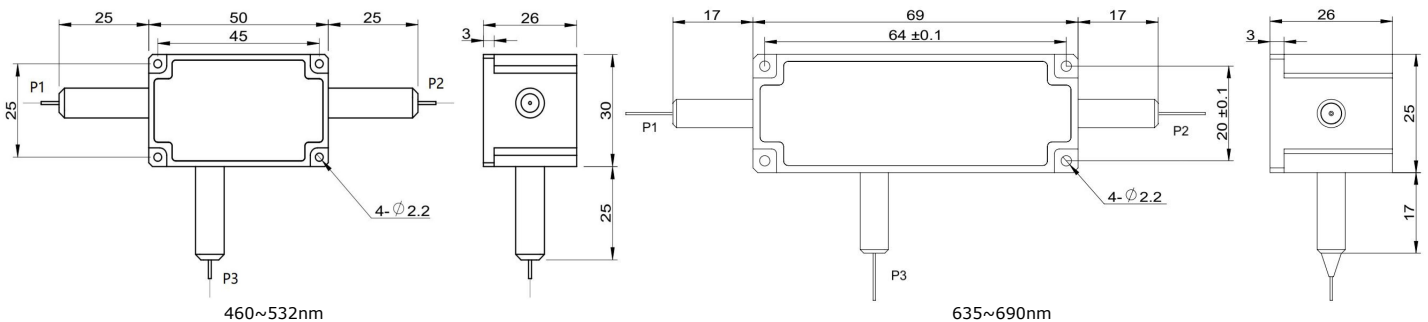

### ORDERING INFORMATION (PN)

<b>FMCR-</b>	<b>NN</b>	<b>-3</b>	<b>C</b>	<b>C</b>	<b>NN</b>	<b>-</b>	<b>CC/CCC</b>
<i>Center Wavelength</i>			<i>Fiber Type</i>	<i>Fiber Sleeve</i>	<i>Fiber Length</i>		<i>Connector Type</i>
460~460nm			5- 50/125um MM Fiber	B- Bare fiber	05-0.5m		N-Without Connector
532~532nm			6- 62.5/125um MM Fiber	L- Loose Tube	10-1.0m		FC/APC=FC/APC Connector
635~635nm			3- OM3 MM Fiber	2- 2mm Cable	15-1.5m		LC/PC=LC/PC Connector
660~660nm				3- 3mm Cable	20-2.0m		SC/UPC=SC/UPC Connector