

1310nm or 1550nm Multimode High Power 3-port Circulator

FEATURES

- ▣ High Isolation
- ▣ Low Insertion Loss
- ▣ Epoxy-Free Optical Path
- ▣ High Reliability and Stability
- ▣ Low Profile Packaging

APPLICATIONS

- ▣ Fiber Optic Amplifiers
- ▣ Fiber Optic Instruments
- ▣ WDM Systems
- ▣ Dispersion Compensation
- ▣ Light Routing

SPECIFICATIONS

Parameter	Unit	Value	
Center Wavelength	nm	1310, 1550, 1590	
Bandwidth	nm	+/-10	
Insertion Loss	(Typ.)	dB	0.8
	(Max.)	dB	1.3
Isolation@23°C	dB	≥18	
Optical Return Loss	dB	≥30	
Cross Talk	dB	≥30	
Fiber Type	-	50/125um MM Fiber (OM2) or 62.5/125um MM Fiber (OM1) 50/125um OM3 MM Fiber (3) or 50/125um OM4 MM Fiber (4) 105/125um MM Fiber NA=0.22 (A) or NA=0.15 (B)	
Fiber Tensile Load	N	5	
Maximum Average Power	W	0.3, 0.5, 1, 2, 3, 5, 10, 15, 20, 25, 30	
Max. Peak Power for Pulse	kW	0.1, 1, 2, 3, 5, 10, 15, 20	
Operating Temperature	°C	0~50	
Storage Temperature	°C	-40~85	

- Note:**
1. Specifications are for device without connectors; Specifications may change without notice.
 2. To add connectors, IL is 0.3dB higher, RL is 10dB lower.
 3. Above specifications are measured at low order modes.
 4. Only guarantee 1W continuous wave (CW) power thru testing for connectors added.
 5. Devices for higher optical power or with other type fiber or consigned fiber are also available.
 6. Package may be different for different fiber type and optical power.

PACKAGE DIMENSION

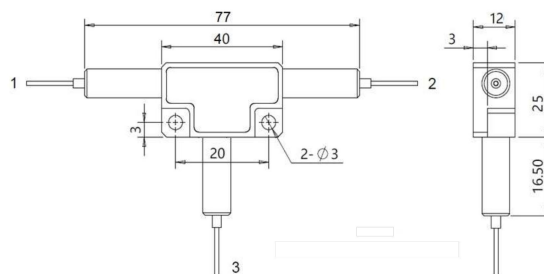

ORDERING INFORMATION (PN)

Center Wavelength	Average Power	Peak Power	Average Power P2	Fiber Type	Fiber Sleeve	Fiber Length	Connector Type
1310-1310nm	03- 300mW	01- 100W	1- 1W	5- 50/125um MM Fiber	B- Bare Fiber	05-0.5m	N-Without Connector
1550-1550nm	1- 1 Watts	1- 1kW	2- 2W	6- 62.5/125um MM Fiber	L- Loose Tube	10-1.0m	FC/APC=FC/APC Connector
1590-1590nm	5- 5 Watts	3-3kW	5-5W	3- OM3 MM Fiber	2- 2mm Cable	15-1.5m	LC/PC=LC/PC Connector
	20- 20 Watts	10- 10kW	Blank for P2=P1	A- 105/125 NA=0.22 MM Fiber B- 105/125 NA=0.15 MM Fiber	3- 3mm Cable	20-2.0m	SC/UPC=SC/UPC Connector

