

960~1120nm High Power MM Optical Isolator for Pulse Power

FEATURES

- High Isolation
- Epoxy-Free Optical Path
- High Reliability and Stability
- Fiber Optic Amplifiers
- Fiber Optic Instruments
- Transmitters and Fiber Lasers

APPLICATIONS

SPECIFICATIONS

| Parameter | Unit | High Power Type |
|--|-------------------------------|--|
| Center Wavelength (λ_c) | nm | 975, 980, 1000, 1020, 1030, 1040, 1053, 1064, 1070, 1080, 1092, 1103, 1120 |
| Operating Wavelength Range | nm | +/-10 |
| Peak Isolation (Typ.) | dB | 28 |
| Min. Isolation (23°C) | dB | 20 |
| Typical Insertion Loss (λ_c , 23°C) | dB | 1.2 |
| Max. Insertion Loss (λ_c , 23°C) | dB | 1.8 |
| Optical Return Loss (Input/Output) | dB | ≥ 25 |
| Configuration | - | Standard: 2-Port; Y Type: 3-Port, Backward Power Guide Out |
| Fiber Type | Input&Output | 50/125um or 62.5/125um MM Fiber 50/125um MM OM3 Fiber |
| | 3 rd Port (Y Type) | Same Fiber |
| Fiber Tensile Load | N | 5 |
| Max. Optical Power (CW) | W | 1, 2, 3, 5, 10, 15, 20, 30, 40, 50, 60, 80, 100 |
| Max. Backward Optical Power (CW) | W | 0.3, 0.5, 1, 2, 3, 5, 10 |
| Operating Temperature | °C | 0~50 |
| Storage Temperature | °C | -20~75 |

- Note:**
- Specifications are for device without connectors; Specifications may change without notice.
 - To add connectors, IL is 0.3dB higher, RL is 10dB lower.
 - Only guarantee 1W continuous wave (CW) power thru testing for connectors added.
 - Suggest to use Y type for >20W Optical Power or continuous backward power of ≥ 500 mW.
 - Devices for higher optical power or with other type fiber or consigned fiber are also available.
 - Specifications are tested at low order modes.
 - Package dimensions may be slightly different for different optical power.

PACKAGE DIMENSION

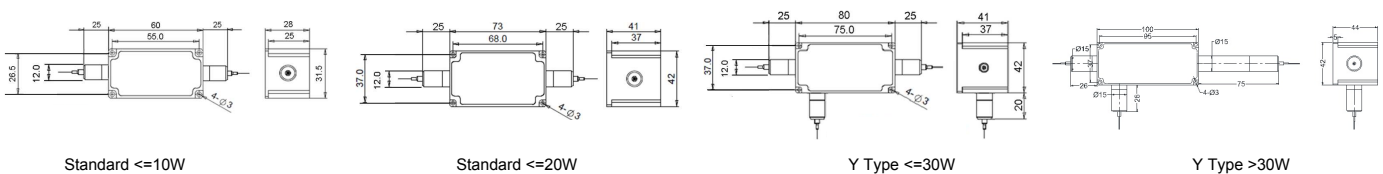

ORDERING INFORMATION (PN)

| FMIS-NNNN | - (C) | HP NN | - (NN) | - C | C | NN | - CC/CCC |
|-------------------|----------------------------|---------------|-----------------|------------------------|---------------|--------------|-------------------------|
| Center Wavelength | 3 rd Port Fiber | Optical Power | Backward Power | Fiber Type | Fiber Sleeve | Fiber Length | Connector Type |
| 980-980nm | Y= Same Fiber | 1-1W | 05-500mW | 5- 50/125um MM Fiber | B= Bare Fiber | 05-0.5m | N=Without Connector |
| 1064-1064nm | Blank for Standard | 5-5W | 1-1W | 6- 62.5/125um MM Fiber | L= Loose Tube | 10-1.0m | FC/APC=FC/APC Connector |
| 1080-1080nm | | 10-10W | 10-10W | 3- OM3 MM Fiber | 2- 2mm Cable | 15-1.5m | LC/PC=LC/PC Connector |
| 1120-1120nm | | 100-100W | Blank for 300mW | | 3- 3mm Cable | 20-2.0m | SC/UPC=SC/UPC Connector |