

2090nm 3-port Optical Circulator for Pulse Power

FEATURES

- High Isolation
- Low Insertion Loss
- High Reliability and Stability
- Various Bandwidth
- High Optical Power

APPLICATIONS

- Broadband Systems
- Optical Amplifying Systems
- Telecommunication Networks
- Laser Systems
- Research Labs



SPECIFICATIONS

Parameter	Unit	A Type	B Type	C Type
Working Wavelength (λ)	nm	2090 \pm 10		
Insertion Loss@23°C	Typ.	dB	1.9	1.7
	Max.	dB	2.8	2.5
Isolation@23°C	(Typ.)	dB	32	18
	(Min.)	dB	28	16
Extinction Ratio	dB	\geq 18		
Optical Return Loss	dB	\geq 45		
Cross Talk	dB	\geq 40		
Work Mode	S Type	-	Can only work in slow axis	
	F Type	-	-	Both Axis working
Fiber Type	-	PM1550 Panda Fiber or PM1950 Fiber (V) 10/130um PMDC Fiber (O) or 25/250um PMDC Fiber (R)		
Fiber Tensile Load	N	5		
Max. Average Optical Power	W	0.3, 0.5, 1		0.3, 0.5, 1, 2, 3, 5, 10
Max. Peak Power for Pulse	kW	0.1, 1, 2, 3, 5, 10, 15, 20		
Operating Temperature	°C	0~50		
Storage Temperature	°C	-20~75		
Package	Stainless Steel Tube (SST)	mm	\varnothing 5.5xL35	
Dimension	Metal Box	mm	L120xW12xH10	

- Note:**
- Specifications are for device without connectors; Specifications may change without notice.
 - To add connectors, IL is 0.3dB higher, RL is 5dB lower, ER is 2dB Lower, Connector key is aligned to slow axis.
 - Only guarantee 1W continuous wave (CW) power thru testing for connectors added.
 - Devices for higher optical power or with other type fiber or consigned fiber are also available; Devices can only work in the core of Double Cladding (DC) Fiber, Cladding Power must be stripped before connecting the device.
 - Package size may be different for different optical power and fiber type.

PACKAGE DIMENSION (TYPE C)

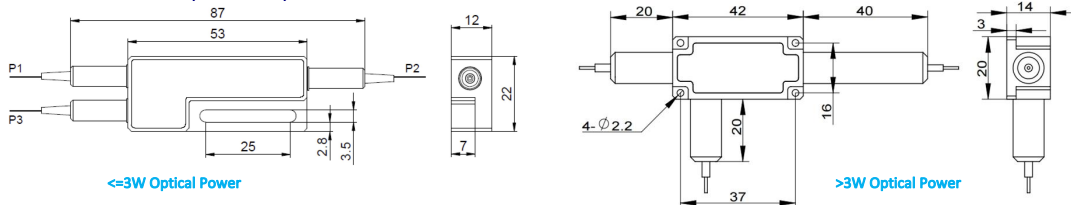

ORDERING INFORMATINO (PN)

Center Wavelength	Work Mode	Type	Average Power	Peak Power	Average Power P2	Package	Fiber Type	Fiber Sleeve	Fiber Length	Connector Type
2090-2090nm	F-F Type	A-A Type	03-300mW	01-100W	1-1W	M-Metal Box	2- PM1550 Fiber	B- Bare Fiber	05-0.5m	N-Without Connector
	Blank for S Type	C-C Type	1-1W	1-1kW	2-2W	Blank for SST	V- PM1950 Fiber	L- Loose Tube	10-1.0m	FC/APC-FC/APC Connector
		Blank for B Type	2-2W	5-5kW	5-5W	or C Type	O-10/130 PMDC Fiber	2-2mm Cable	15-1.5m	LC/PC-LC/PC Connector
		or C Type(>1W Power)	3-3W	10-10kW	Blank for P2=P1		R-25/250 PMDC Fiber	3-3mm Cable	20-2.0m	SC/UPC-SC/UPC Connector

