

Polarization Maintaining Isolator for Pulse Power

FEATURES

- High Isolation
- Low Insertion Loss
- Epoxy-Free Optical Path
- High Reliability and Stability
- Low Profile Packaging

APPLICATIONS

- Fiber Optic Amplifiers
- Fiber Optic Instruments
- WDM Systems
- Transmitters and Fiber Lasers
- CATV Networks



SPECIFICATIONS

Parameter	Unit	Single Stage	Dual Stage	H Stage
Center Wavelength (λ_c)	nm	1310, 1480, 1550, 1590		
Peak Isolation (Typ.)	dB	42	58	35
Isolation ($\lambda_c \pm 15\text{nm}$, 23°C)	dB	≥ 28	≥ 45	≥ 25
Insertion Loss (λ_c , 23°C)	dB	≤ 0.4	≤ 0.5	≤ 0.5
Insertion Loss ($\lambda_c \pm 20\text{nm}$, 0-70°C)	dB	≤ 0.6	≤ 0.7	≤ 0.8
Optical Return Loss (Input/Output)	dB	55/50	55/50	55/50
Extinction Ratio	dB	≥ 18		
Working Mode	S Type	-	Can only work in Slow Axis	
	F Type	-	Can work both in Slow Axis and Fast Axis	
Fiber Type	-	PM1550 Panda Fiber or 10/125um PMDC Fiber NA=0.08 (O)		
	-	10/130um PMDC Fiber NA=0.15 (O2) or 12/130um PMDC Fiber (T)		
	-	25/250um PMDC Fiber (R) or 25/300um PMDC Fiber (G)		
Fiber Tensile Load	N	5		
Max. Average Optical Power	W	0.3, 0.5, 1, 2, 3, 5 10		15, 20, 30
Max. Peak Power for Pulse	kW	0.1, 1, 2, 3, 5, 10, 20		
Operating Temperature	°C	0~50		
Storage Temperature	°C	-40~85		
Package Dimension	Stainless Steel Tube (SST)	mm	$\phi 5.5 \times L35$ ($\leq 5\text{W}$), $\phi 6.0 \times L50$ ($> 5\text{W}$)	
	Metal Box-M	mm	$L120 \times W12 \times H10$	

- Note:**
- Specifications are for device without connectors; Specifications may change without notice.
 - To add connectors, IL is 0.3dB higher, RL is 5dB lower, ER is 2dB Lower, Connector key is aligned to slow axis.
 - Only guarantee 1W continuous wave (CW) power thru testing for connectors added.
 - Devices for higher optical power or with other type fiber or consigned fiber are also available; Devices can only work in the core of Double Cladding (DC) Fiber, Cladding Power must be stripped before connecting the device.
 - Package size may be different for different optical power and configurations.

PACKAGE DIMENSION (H STAGE)

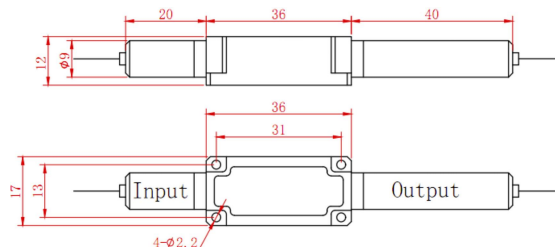

ORDERING INFORMATION (PN)

FPIS-NNNN	- C	C	- H NN	P NN	- (NN)	-(C)	C	C	NN	-CC/CCC
Center Wavelength	Stage	Type	Average Power	Peak Power	Backward Power	Package	Fiber Type	Fiber Sleeve	Fiber Length	Connector Type
1310-1310nm	S= Single Stage	S= S Type	05= 500mW	01=100W	05= 500mW	M=Metal Box	2-PM1310/1550 Fiber	B=Bare Fiber	05=0.5m	N=Without Connector
1550-1550nm	D= Dual Stage	F= F Type	1= 1 Watts	1= 1kW	1= 1 Watts	Blank for SST	0=10/125 PMDC Fiber	L=Loose Tube	10=1.0m	FC/APC=FC/APC Connector
1480-1480nm	H= H Stage		5= 5 Watts	5=5kW	5= 5 Watts	or >10W	T=12/130 PMDC Fiber	2=2mm Cable	15=1.5m	LC/PC=LC/PC Connector
1590-1590nm			10= 10 Watts	10=10kW	Blank for 300mW		R=25/250 PMDC Fiber	3= 3mm Cable	20=2.0m	SC/UFC=SC/UFC Connector