

## 750~860nm Pump Laser Protector with Isolator

### FEATURES

- High Isolation
- Low Insertion Loss
- Epoxy-Free Optical Path
- High Reliability and Stability
- Low Profile Packaging

### APPLICATIONS

- Broadband Systems
- Optical Amplifying Systems
- Telecommunication Networks
- Metro Networks
- CATV Networks

### SPECIFICATIONS

Parameters	Unit	Standard	High Signal Isolation
Pump Laser Wavelength	nm	750±10, 780±10, 793±10, 808±10, 830±10, 850±10	
Blocking Signal Wavelength	Type 5	nm	1500~1620
	Type 2	nm	1020~1120&1500~1620
	Type 8	nm	880~1100
	Type 9	nm	1900~2070
Pump Insertion Loss@23°C	dB	≤1.5	≤1.8
Backward Pump Isolation@23°C	dB	≥22	
Backward Signal Attenuation	dB	≥25	≥45
Configuration	D Type	-	2-port
	Y Type	-	3-port, (Backward Signal/Pump Guide Out)
Return Loss	dB	≥50	
PDL	dB	≤0.2	
Fiber Type	Input&Output	-	HI780 Fiber or 780-HP Fiber
	3 <sup>rd</sup> Port (Only for Y Type)	-	Same Fiber or 105/125um MM Fiber
Fiber Tensile Load	N	5	
Max. Optical Power (Pump+Signal, CW)	W	0.3, 0.5, 1, 2, 3, 5, 10, 15, 20	
Max. Backward Signal/Pump Power (CW)	W	0.3, 0.5, 1, 2, 3, 5, 10	
Operating Temperature	°C	0~50	
Storage Temperature	°C	-20~75	

- Note:**
- Specifications are for device without connectors; Specifications may change without notice.
  - To add connectors, IL is 0.7dB higher, RL is 5dB lower.
  - Only guarantee 1W continuous wave (CW) power thru testing for connectors added.
  - Devices for higher optical power or with other type fiber or consigned fiber are also available; Devices can only work in the core of Double Cladding (DC) Fiber, Cladding Power must be stripped before connecting the device.
  - Suggest to use Y/X type if blocked optical power is >1W.
  - Package size may be different for different optical power, fiber type and configurations.

### DIMENSION DRAWING

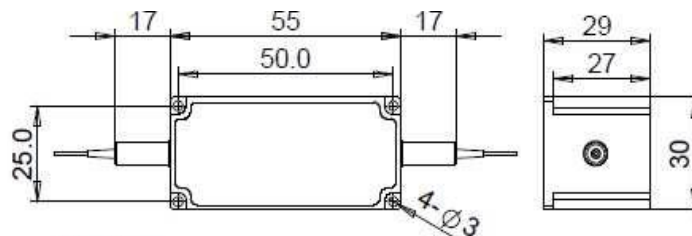

### ORDERING INFORMATION (PN)

FSPI-NNN	- N	(C)	(C)	(C)	-P NN	- (NN)	-(C)	C	NN	-CC/CCC
Center Wavelength	Signal Type	Signal Isolation	B.Signal Fiber	B.Pump Guide Out	Optical Power	B.Signal/Pump Power	Fiber Type	Fiber Sleeve	Fiber Length	Connector Type
780~780nm	9= Type 9	I=High Isolation	Y= Same Fiber	P= Yes	05=500mW	05= 500mW	7=780HP Fiber	B= Bare fiber	05=0.5m	N=Without Connector
793~793nm	5= Type 5	Blank for Standard	A=105/125um Fiber	Blank for	1= 1W	1= 1W	Blank for HI780 Fiber	L= Loose Tube	10=1.0m	FC/APC=FC/APC Connector
808= 808nm	2=Type 2		Blank for D Type	D Type or No	5= 5W	5= 5W		2= 2mm Cable	15=1.5m	LC/PC=LC/PC Connector
830= 830nm	8=Type 8				10=10W	Blank for 300mW		3= 3mm Cable	20=2.0m	SC/UP=SC/UPC Connector

